

# **GLOBAL COMPACT COP/2017**

By  
Schmidt Hammer Lassen Architects





## **Content/**

- 04 About us
- 07 Statement of support/ CEO
- 09 The Global Compact/ Principles
- 10 We support
- 11 Principles/ Human Rights
- 14 Principles/ Labour Standards
- 21 Principles/ Environment
- 29 Principles/ Anti-corruption
- 33 Selected Architecture
- 55 Imprint

**We aspire to the highest standard in everything we do.  
Driven by the vocation that great architecture generates  
lasting and positive change, we combine intelligent  
solutions with exceptional experiences that appeal  
to senses and mind.**



## About us

Schmidt Hammer Lassen is an international architecture practice and one of Scandinavia's most recognized, award-winning studios committed to innovative and sustainable design.

Schmidt Hammer Lassen was founded in Denmark in 1986 and the practice has since grown substantially and now employs 175 staff, working out of studios in Aarhus, Copenhagen and Shanghai. The practice upholds a distinguished track record of architecture across a broad spectrum of building typologies and has established a reputation for devising truly sustainable solutions with high emotional value, that benefit the environment, society, user, and the overall economy. Adopting a holistic approach, we believe that the basis of sustainable design is the understanding that every component influences the project. We continuously challenge the concept of architecture by adding innovative methodology and technology to classic Scandinavian design traditions.

Schmidt Hammer Lassen have supported the UN Global Compact initiative since 2008 and submits COP #8 in December 2017.

The COP is available on the UN Global Compact website and on **[www.shl.dk](http://www.shl.dk)**

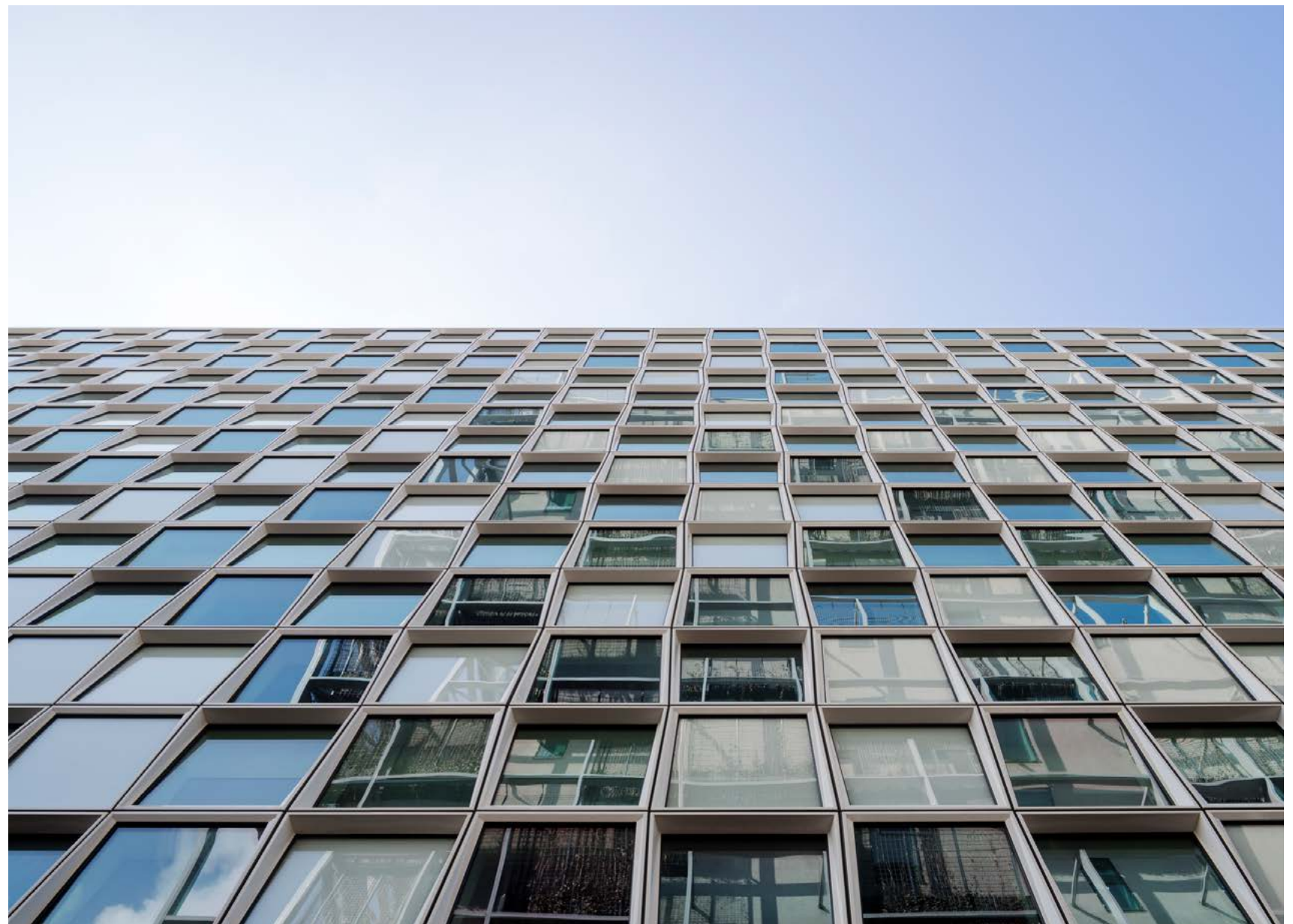



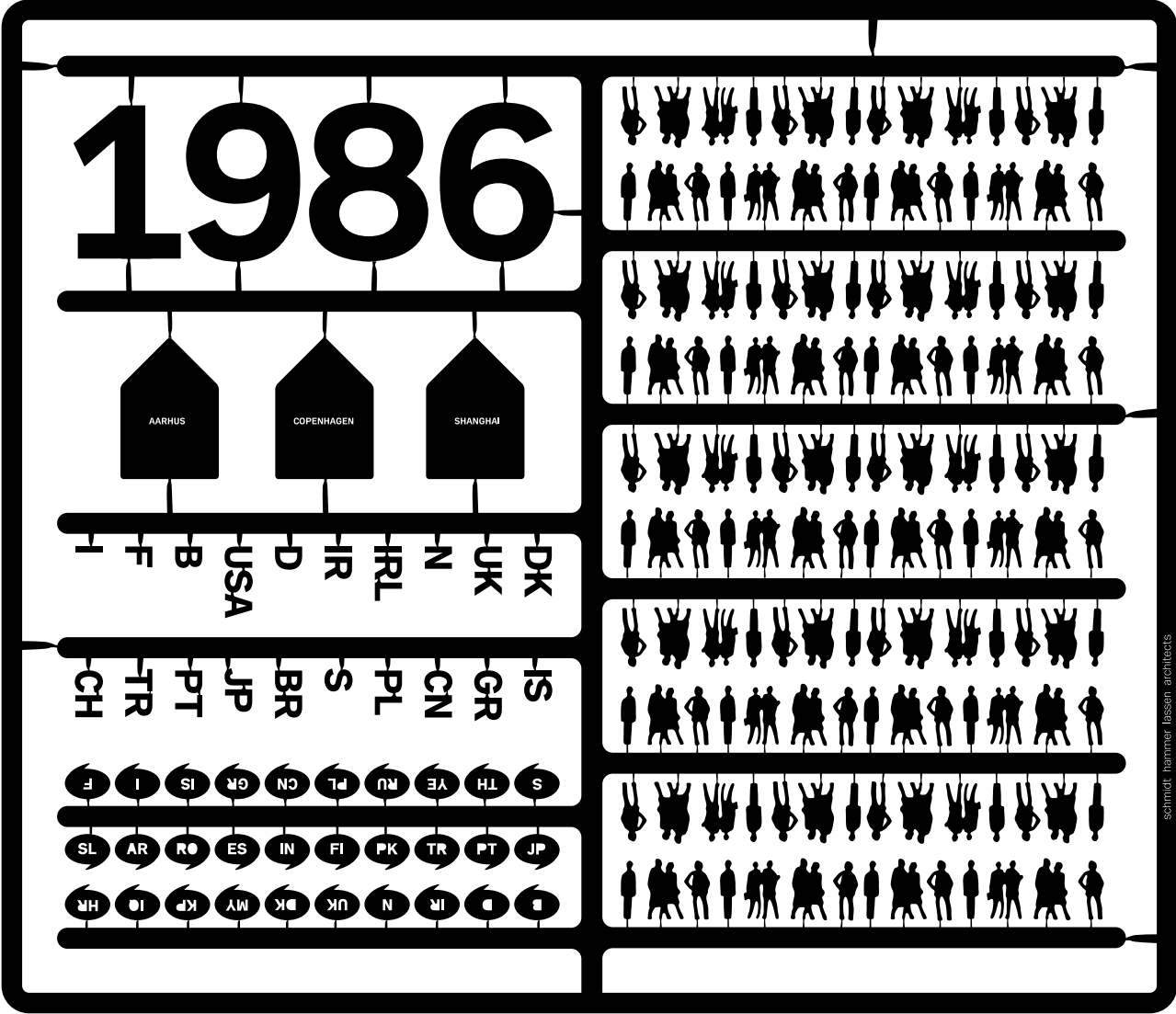

Founded in 1986  
3 offices  
175 co-workers  
20 nationalities  
International projects on 4 continents



The group of partners includes senior partners Morten Schmidt, Bjarne Hammer, John F. Lassen, Kim Holst Jensen and Kristian Lars Ahlmark, along with partners Chris Hardie and Rong Lu. Day-to-day management of the practice is the responsibility of CEO Bente Damgaard.



# Statement of Support/

CEO Bente Damgaard

**schmidt/hammer/  
lassen/**



**BENTE DAMGAARD/**

MSc in Accounting & State Authorized Public Accountant  
CEO of Schmidt Hammer Lassen Architects since 2006

For more than 30 years, Schmidt Hammer Lassen have provided excellent architectural services all over the world. Today we work on four continents with the overall goal to optimize and improve existing standards for building design and construction.

We believe that architecture solutions increasingly can and will drive positive change in our world. To accomplish this, we continuously seek to get smarter through new knowledge and methodology. We engage in innovative research projects, establish collaborative partnerships with both industry and higher education institutions, and we provide targeted internal continuing professional development to all staff members.

In our COP/2017, we take the opportunity to report on initiatives taken and achievements attained and we present selected architectural projects that add documented value and positive change to people, places and communities. In acknowledgement of the substantial influence and responsibility of the building industry, Schmidt Hammer Lassen have signed the Nordic Built Charter as well as The Charter of the Danish Association for Responsible Construction.

Since 2008, we have supported the Global Compact initiative and the principles continuously constitute an essential policy frame of our CSR approach. In October 2017, we were excited to join the foundation of the new

Global Compact Network Denmark. We are looking forward to be part of the Danish network working together on “making global goals local business”.



**Bente Damgaard/ CEO**  
December 2017

**architects/**

## **The UN Global Compact/**

Schmidt Hammer Lassen Architects joined the UN Global Compact initiative in 2008. Global Compact is the world's largest voluntary CSR initiative and initiates and supports corporate operational and strategic focus on social responsibility. This important initiative was started in 2000 under the leadership of then Secretary General Kofi Annan. The overall goal is to actively commit companies to work

to improve the major social, economic and environmental challenges that follow globalization. Global Compact has today grown to be an extensive international network of more than 12,000 signatories from over 170 countries. Global Compact's ten fundamental principles constitute the core of the stated objectives and cover four key focus areas: human rights, labour rights, environment, and anti-corruption.





A high-angle photograph of two people sitting on a wooden deck. The person on the left is wearing a light-colored jacket and a backpack, while the person on the right is wearing a dark jacket and blue pants. They are both looking out over a body of water. The deck is made of light-colored wooden planks, and the water is a deep blue. The sky is a pale blue with some white clouds.

# 10 GUIDING PRINCIPLES

## Human Rights/

- Principle 1 Businesses should support and respect the protection of internationally proclaimed human rights; and  
Principle 2 Businesses should make sure that they are not complicit in human rights abuses.

## Labour Standards/

- Principle 3 Businesses should uphold the freedom of association and the effective recognition of the right to collective bargaining;  
Principle 4 the elimination of all forms of forced and compulsory labour;  
Principle 5 the effective abolition of child labour;  
Principle 6 the elimination of discrimination in respect of employment and occupation.

## Environment/

- Principle 7 Businesses should support a precautionary approach to environmental challenges;  
Principle 8 undertake initiatives to promote greater environmental responsibility, and;  
Principle 9 encourage the development and diffusion of environmentally friendly technologies.

## Anti-Corruption/

- Principle 10 Businesses should work against corruption in all its forms, including extortion and bribery.



# We support/



## **The UN Sustainable Development Goals**

In 2015, leaders from 193 countries came together to commit to ending poverty, combating climate change, and fighting injustice by adopting a new set of 17 measurable global Sustainable Development Goals (SDGs).

The UN Global Compact is committed to be a leading catalyst of this agenda – based on the sound values and principles that the UN Global Compact is built upon.

Schmidt Hammer Lassen will collaborate with the recently established Global Compact Network Denmark on “making global goals local business”.

## **The World's Best News Campaign/ 2017**

Schmidt Hammer Lassen Architects annually participates as business partner in the Danish information campaign The World's Best News with the overall goal to spread the word, that the United Nations' Global Goals for Sustainable Development are achievable; the world is making huge progress.

As business partner, Schmidt Hammer Lassen mark the official campaign at our offices - outside the organization we contribute by spreading the positive news on our Social Media networks - reaching thousands of readers.

In 2016, the World's Best News was founded as an independent association and the campaign event is a unique collaboration between the UN, DANIDA, and more than 100 Danish NGOs and 100 private sector companies.

Please find more information on the Campaign website:  
**[www.verdensbedstenyheder.dk](http://www.verdensbedstenyheder.dk)**





# PRINCIPLES ON HUMAN RIGHTS

**Principle 1/** Businesses should support and respect the protection of internationally proclaimed human rights; and

**Principle 2/** businesses should make sure that they are not complicit in human rights abuses.



**Schmidt Hammer Lassen Architects support the United Nations' Universal Declaration on Human Rights and the UN Global Development Goals. We work in compliance with Danish legislation which meets international conventions on human rights.**





## **Danish charter supports CSR in the construction sector/**

Schmidt Hammer Lassen joined the Danish Association for Responsible Construction in 2014. The objective of the association is to develop and promote social responsibility in the Danish property and construction sector based on a charter of six principles.

1. We systematically assess whether we are observing the principles of the Charter in the projects in which we are involved
2. We assess how collaboration partners and suppliers manage social responsibility
3. We establish dialogue with collaboration partners and stakeholders
4. We work for sustainable solutions
5. We have sound employment and working conditions
6. We demonstrate independence and anti-corruption practices

By signing the charter Schmidt Hammer Lassen Architects declare our support to the six principles. We believe that cross-disciplinary collaboration will only contribute to strengthen social responsibility within the building sector and will support and inspire good practice.





# PRINCIPLES ON LABOUR STANDARDS

**Principle 3/** Businesses should uphold the freedom of association and the effective recognition of the right to collective bargaining.

**Principle 4/** the elimination of all forms of forced and compulsory labour.

**Principle 5/** the effective abolition of child labour.

**Principle 6/** the elimination of discrimination in respect of employment and occupation.





## Labour rights/

At Schmidt Hammer Lassen Architects, we are exclusively dependent on staff members' performance to continue the success of creating and delivering modern, holistic and sustainable architectural solutions for a diverse and international group of private and public clients. Attracting, retaining, developing, and ensuring the health and safety of the staff members is therefore important to the organizational development and a top priority in the strategic management teams' ongoing efforts to realize the visions of our practice. The Scandinavian countries are by definition attending to secure labour rights and conditions of any staff members through collective agreements and state imposed regulations concerning employee safeguarding.

Additionally, Schmidt Hammer Lassen engage in several specifically selected and designed activities to uphold and extend these rights and continuously improve conditions for all staff members.

In Denmark, a collective agreement is in place and applicable to the majority of the organisation's staff members. Colleagues in Shanghai and minor project offices are not covered by the Danish collective agreement, but the organization has made significant efforts to create conditions comparable to the rights and benefits included in the Danish collective agreement. National rules and regulations in force on the non-Danish office sites are followed with rigor.



## **A democratic work place/**

The well-being of staff members is highly valued by the organisation. Three dedicated committees are in place to support, that we act in compliance with the defined goals and that procedures are followed. The strategic management participates actively and cooperatively in this work alongside staff elected representatives.

**The Health & Safety Committee** takes precautionary measures against any form of counterproductive physical and non-physical working conditions, including the prevention of any labour related accident.

**The Collaboration Committee** ensures a positive working environment and engage in dialogue with union representatives about organisational development and adjustment to foster employee commitment and retention.

**The Continuing Education Committee** organises and administers the organisation's strategic engagements in relation to staff member training and professional development.

We communicate on general work conditions, benefits, rules and regulations in the SHL Staff Hand-book, which we hand out when welcoming a new colleague - alongside a well-planned on-boarding program.



## **Work environment/ Individual development/**

A mandatory and well planned Employee Development Dialogue / EDD is held annually for all staff members together with their manager. This valuable session is focusing on motivation, job satisfaction, continuing professional development and career development. The outcome of the EDD is implemented in the Individual Development Plan/ IDP for each employee – this is done in collaboration with the manager as well. Additionally, there is an annual salary negotiation for every employee together with a status EDD.

At all locations, Schmidt Hammer Lassen encourage the employees to participate in a wide range of social and professional development activities. We love to celebrate won competitions, birthdays and anniversaries by inviting to informal gatherings. The SHL Intranet monthly presents a variety of activities to ensure a spirited culture, including knowledge-sharing sessions, lectures, courses, site visits and inspiring study trips.

### **CPD Plan**

To ensure assisted learning activities and ongoing professional and personal development for all employees, the Continuing Professional Development Committee annually compile a CPD Plan covering the majority of the assisted learning activities open for everyone. Our knowledge groups GREEN/ BIM/ BUILD arrange a variety of educational activities.

In addition to the CPD plan, many different individual learning activities take place, also funded by company means.







Schmidt Hammer Lassen/Office/ Copenhagen/Denmark

### **Work Place Assessment/**

The organisation administers a detailed employee survey, the Workplace Assessment/ WPA. The WPA is conducted once every third year and it support us in monitoring organisational development on physical working conditions as well as psychological working environment.

In 2016, the WPA consisted of 64 questions in 10 categories. The categories covered topics as follows: physical working environment/ the daily work/ professional development/ my manager and reputation. In the assessment, scores range from zero to 100. We consider a score above 70 as satisfactory. In 2016, the number of respondents was 81% and 7 out of 10 categories scored above 70. The categories reputation/ general well-being and on boarding had an impressive score above 80.

Some important questions in the WPA related to job-satisfaction has recurred in the last three surveys, showing a positive steady increase in the categories covering reputation and general well-being.

The Executive Board in collaboration with Health & Safety/ Collaboration Committee / Managers / HR identify the key focus areas to be handled and prioritized in continuation of the employee feedback. Hereafter, action is taken on different organizational levels.

### **Non-discrimination**

Members of staff are the most valuable resource at Schmidt Hammer Lassen. We believe that diversity supports an innovative work environment with excellent architecture as a result. The staff of employees today counts around 20 different nationalities with an almost equal gender distribution. We focus on competencies and skills at any recruitment and internal promotion within the organisation.





### **Collective Agreement/**

In the section below, we outline the basic rules and regulations of the collective agreement pertinent to safeguarding labour rights and we include additional activities designed by the organisation to stimulate a positive working environment, where work life and family life is well balanced.

The Danish Labour Law and Collective Agreement for architects in Denmark provides the following benefits to safeguard employee interests.

- 1/ Fixed salary tiers regulated according to seniority  
+ individually salary negotiations
- 2/ Pension scheme
- 3/ Working hours regulation and overtime compensation
- 4/ Favourable maternity and paternity leave
- 5/ Holiday regulations (31 days per annum)
- 6/ Continuing Professional Development (CPD) funding and shared learning activities
- 7/ Employee representation on several organisational boards  
(Health & Safety committee, Collaboration Committee and Continuing Professional Development Committee)
- 8/ Free union representative elections without management intervention

Additionally, the organisation offer extra health care insurances for a majority of staff members.

### **Responsible behaviour/**

At Schmidt Hammer Lassen responsible behaviour is integrated both in our professional work and in our everyday work life. Standards covering responsible behaviour are thoroughly described in the SHL Staff Handbook.

A lunch scheme is in place at the Danish offices, allowing staff members to enjoy healthy, fresh and well-prepared lunch meals. We avoid waste of food by offering a take-away solution. The supplier is certified with the Organic Trademark verified by the Danish Veterinary and Food Administration.



**schmidt/hammer/  
lassen/**

**SHL DAYS/  
SHANGHAI 2016**

**architects/**

## **SHL DAYS/**

At Schmidt Hammer Lassen, we have proud traditions when it comes to our grand gatherings; the SHL Days.

Every second year, all staff members are invited to come together for a couple of days, to get inspired, to experience excellent architecture and to enjoy the company of good colleagues.

In 2016, the SHL Days took place in Shanghai. 150 staff members set out to meet at a four-day adventurous architect-tour in one of the world's most fascinating and fastest growing cities.

We wanted to experience the unique atmosphere of Shanghai, where beauty and charm coexist with kitsch and commercialism. From the air, waterfront and ground we explored traditional and new architecture by Chinese and international architects, among these selected projects by Schmidt Hammer Lassen.

**architects/**

A photograph of the Vaxjo City Library building, featuring a large, curved glass facade that reflects the sky and shows interior bookshelves. The building is situated on a grassy area with some trees in the background.

# GLOBAL COMPACT PRINCIPLES ON ENVIRONMENT

**Principle 7/** Businesses should support a precautionary approach to environmental challenges;

**Principle 8/** undertake initiatives to promote greater environmental responsibility, and;

**Principle 9/** encourage the development and diffusion of environmentally friendly technologies.



**Above all, sustainability is about responding to the basic needs of a client, which can be an individual, a commercial enterprise, a school or an entire community.**

**In the final analysis, sustainability is about delivering design that functions successfully as a catalyst for positive change. In other words, we are talking about successful place-making: when it works, sustainable design can engender a sense of civic pride, a sense of identity. This is an extraordinary challenge for architects – it is at the very heart of what we do.**

**The Green Manifesto/ Schmidt Hammer Lassen Architects**

## The new Sports and Administrations Centre and Town Hall in Skanderborg is the first Danish public building to reach the DGNB Platinum Standard



## A GREEN agenda/ Certified knowledge

At Schmidt Hammer Lassen Architects, we commit to develop projects and realise buildings based on a holistic concept of sustainability. We work in multidisciplinary teams with innovative solutions in integrated design processes. We do this in frameworks of various certification systems as well as project specific goal setting working closely together with our clients organisation.

Our architectural staff counts in-house experts in the most important building certification systems, BREEAM International Assessors, LEED Ac-credited Professionals, DGNB International and DGNB Denmark Consultants and Cradle to Cradle trained professionals, offering certification processes and benchmarking for our clients projects. This enables us to evaluate the “green performance” of a building and give a profound understanding of the interaction of different sustainable parameters. The evaluations are used to seek for optimized green solutions during the design process and better building performances without compromising the ambition for high quality architecture.

Knowledge sharing is fundamental in our practice and in the CPD strategy.. The CPD strategy aids to raise the common level and understanding of holistic sustainability throughout all of SHL. An important knowledge sharing platform is our GREENgroup, where passionate employees exchange cutting edge knowledge of highly sustainable projects and green ideas. In close collaboration with the architecture schools and university colleges we engage with students in different ways as mentors and external examiners in mutual inspiration.

We participate in network initiatives with the focus on implementation of green value management, sustainable reuse of existing building mass and sustainable city development. The specialized staff members of our studio provide public lectures and communicate on our experienced work. We engage in strategic partnerships in pursuit of working with the UN Sustainable Development Goals - like the Active House Alliance, where SHL is a supporting member and represented in the Advisory Board.





# Selected certified projects/ by Schmidt Hammer Lassen Architects

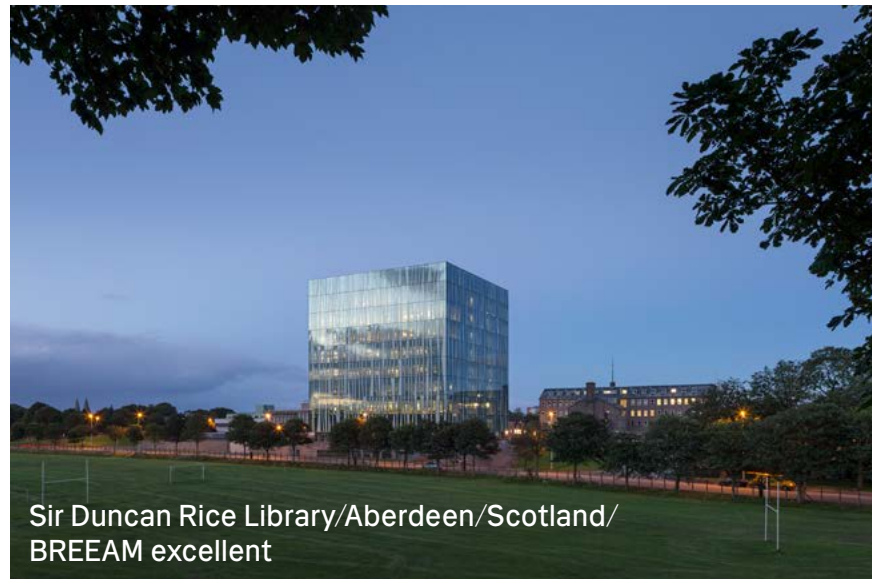







# Building Information Modelling/ BIM

Sustainability and Building Information Modelling/ BIM go hand in hand. At Schmidt Hammer Lassen, we have been working with BIM for many years, and today execute all major projects with the use of BIM.

Internally, BIM is used to develop and validate the designs of our buildings with the use of sustainable analysis and simulations, which allows us to optimize documentation of the project for construction. Externally, BIM is used on all project organization levels to communicate the design - enabling a smoother decision making process.

The result is an optimally coordinated process and collaboration and minimisation of errors. We facilitate the dialogue with clients and related stakeholders to clarify and define the scope of information and data which need to be successfully handed over on delivery of the project, for better and lower cost facility management.

When environmental analysis and simulation tools are used from the earliest stages of a design process, projects can be designed to benefit from local environmental conditions such as site orientation, solar access and seasonal winds as well as support selection of the used materials. For the client, coming user and the community, this means a more sustainable, enduring and energy efficient building.

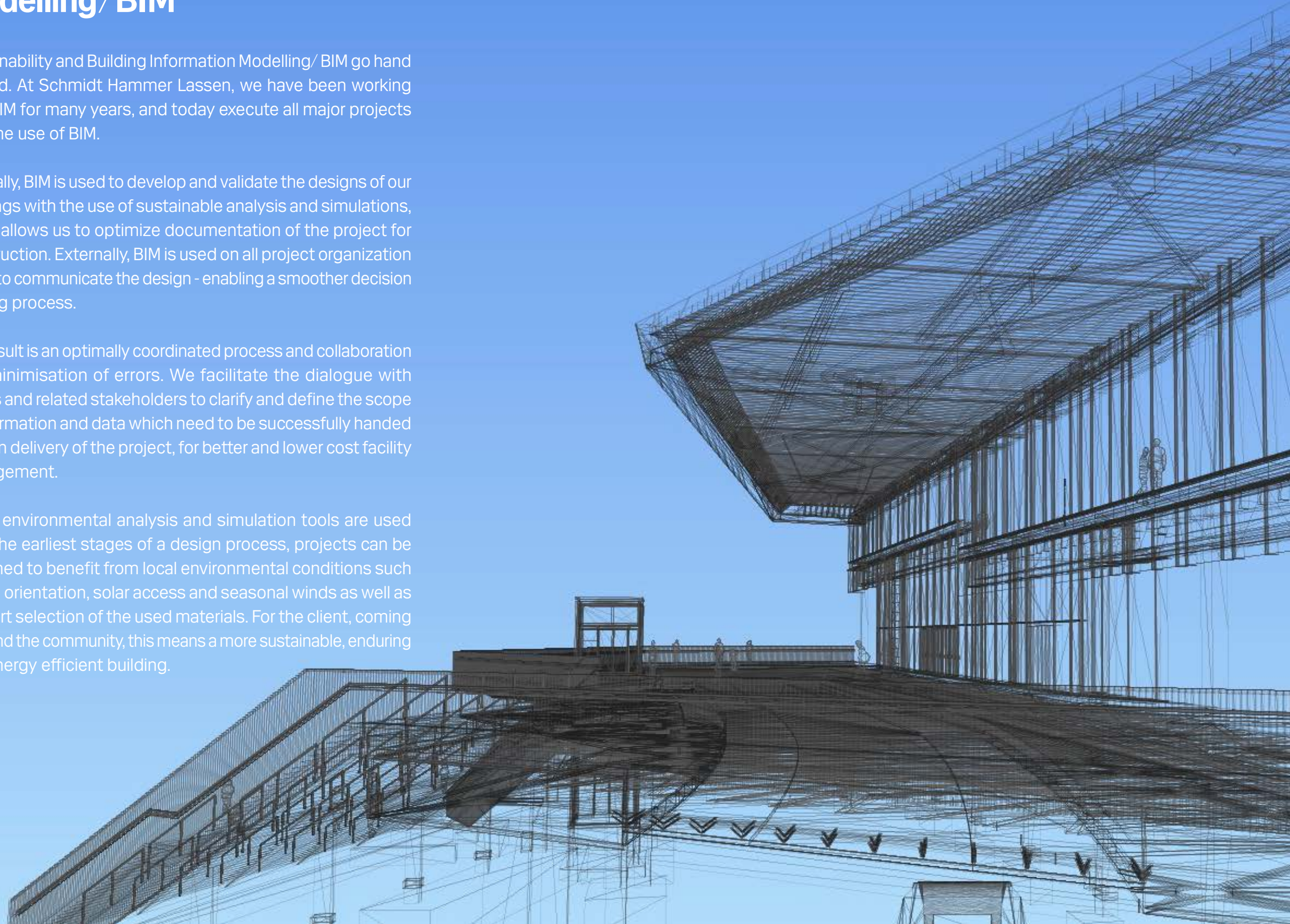



## **Building new knowledge/**

Successful integration of new methods and technologies requires an extensive level of knowledge sharing. Therefore, the BIM management group engages in BIM Networks, BIM standard organisations and conferences, and also lectures at conferences and educational institutions. These activities are essential in order to build and share new knowledge – internally as well as externally.

Schmidt Hammer Lassen is co-founder and member of the BIM7AA, a voluntary collaboration between seven Danish architectural practices in collaboration with the Aarhus School of Architecture. The purpose of BIM7AA is to develop and continuously optimise commonly developed BIM-tools, -methods and -processes with focus on interdisciplinary cooperation.

### **Knowledge Centre/ Molio**

Schmidt Hammer Lassen is also member of Molio, a construction knowledge centre focusing on digital solutions and new technology. Molio is taking over the role as the buildingSMART network in Denmark and will also be the new buildingSMART Nordic Chapter partner and coordinator of activities in Denmark.

BIM is also one of the key cornerstones in the internal strategic continuing education plan. Additional BIM has its own internal taskforce and a separate internal budget as Schmidt Hammer Lassen acknowledges that being a first mover on this field requires constant research, a large professional network and education. Running evaluations of the BIM projects is part of these knowledge sharing initiatives.

### **Links/**

[www.molio.dk](http://www.molio.dk)



# Quality Assurance/

**schmidt/hammer/  
lassen/**

Schmidt Hammer Lassen have wide-ranging experience in high-level quality management to meet both client demands and regulatory requirements - from the very beginning of a project until final handover.

Working internationally, the applied Quality Assurance standards need to be applicable to the multitude of projects, that we work on all over the world, as well as support the unique architectural quality.

The quality assurance policy of the practice is described in detail in the SHL Quality Assurance Manual, and it has been prepared in accordance with the following guidelines and standards:

- / Quality Control in Architectural Practices published by The Danish Association of Architectural Firms
- / The DS/ISO 9001 standard

The SHL Quality Assurance Manual is a process tool that includes guidelines and standards for planning, implementation and quality control. The Handbook is verified and updated on an ongoing basis.

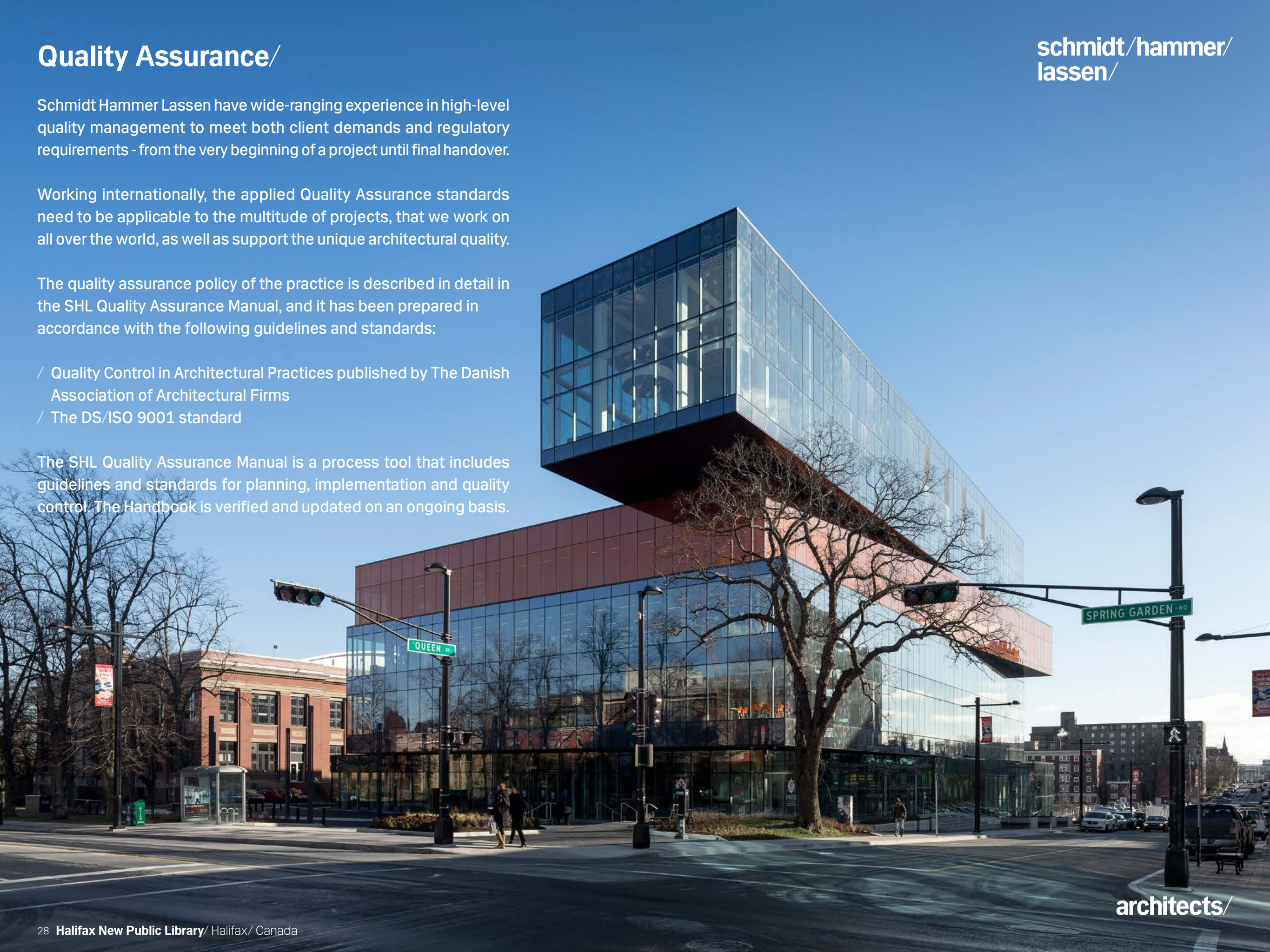

**architects/**





# GLOBAL COMPACT PRINCIPLES ON **ANTI-CORRUPTION**

**Principle 10/** Businesses should work against corruption in all its forms, including extortion and bribery.



# Business Ethics/

The independent international NGO, Transparency International was founded in 1993 and is now present in more than 100 countries. The organization annually publishes reports on corruption – and for many years Denmark has been placed as one of the world's least corrupt countries. The result underlines the very high standards of Danish companies.

We hold a reputation as a responsible and conscientious business partner and dissociate from corruption, extortion, and bribery in any form. The studio has never been involved in corruption or bribery and the company has worked out policy guidelines which are carefully described in the Schmidt Hammer Lassen Staff Handbook that is handed out to all employees on their first day at work. In this we state that:

„Our business ethics are grounded on trustworthiness, honesty and transparency. Accordingly, employees at all levels must avoid letting financial and/or personal interests influence – or arouse suspicion of influencing their work-related decisions or conflicting with the interests and ethics of the organisation. Moreover, we expect all employees to act in accordance with applicable legislation.“





**In 2015 Nordic Innovation published  
the book "30 Sustainable Nordic buildings"  
featuring best practice examples based on the  
Nordic Built Charter principles.**

**Schmidt Hammer Lassen's highrise winning  
project in downtown Oslo, the Urban Mountain,  
will become another icon of the Norwegian capital  
and sets new standards for sustainability.**



# The Nordic Built Charter/

Schmidt Hammer Lassen Architects have signed the Nordic Built Charter; committed to accelerate the development of sustainable building concepts initiated by the Nordic ministers for trade and industry. The Nordic Built Charter is a public declaration of the values, intentions and ambitions of a united Nordic building sector. It describes a holistic approach to the built environment – taking energy, climate, economy and people into account.

The intention is that relevant actors from across Nordic borders and across the entire value chain of the building sector will commit to its ten principles. In short, The Nordic Built Charter gives the building sector a platform for cooperation and provides a common set of fundamentally Nordic and sustainable values, promoting a balanced and integrated societal development based on environmental, economic and social sustainability.

The Nordic Built programme combines key Nordic strengths, provides attractive and effective arenas for collaboration and realizes concrete projects that demonstrate world-class scalable solutions.

In 2012 the Nordic Built Challenge – a high profiled international architectural competition - was organized by Nordic Innovation. The ambition were to create five lighthouse projects for the Nordic region, one in each country, demonstrating the solutions for sustainable refurbishment of the existing building stock, which the Nordic building industry is able to deliver.

With the Urban Mountain refurbishment project Schmidt Hammer Lassen and team won 1<sup>st</sup> prize for the innovative and sustainable new landmark for the city of Oslo.

## More information:

[www.nordicinnovation.org/nordicbuilt/the-challenge/](http://www.nordicinnovation.org/nordicbuilt/the-challenge/)





# SELECTED ARCHITECTURE/ SOCIAL/ SUSTAINABLE/ IMPACT/



# Skanderborg Fælled/ Sports and Administration Centre/ Town Hall/Skanderborg/Denmark

First DGNB Platinum certification to Danish public building





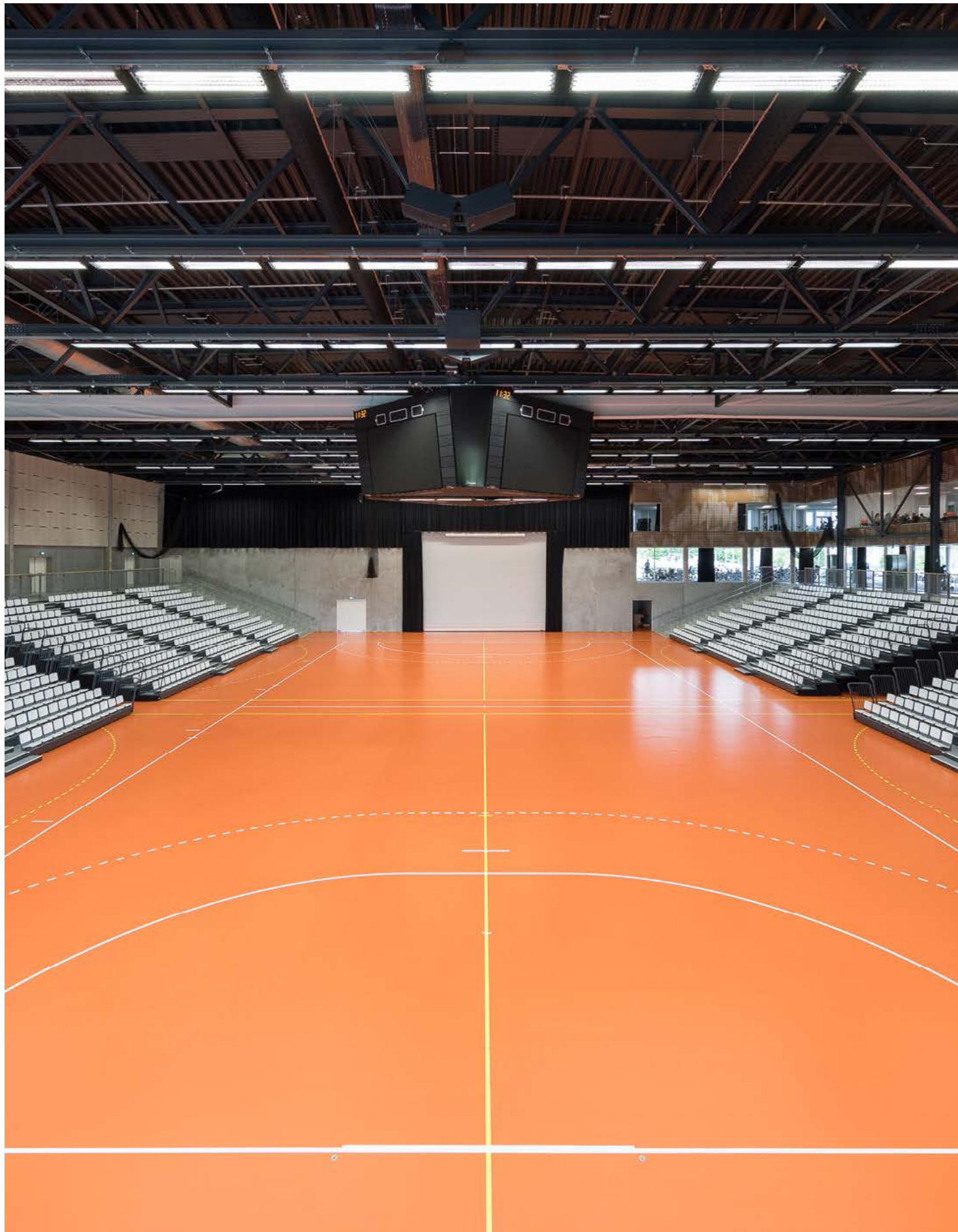

### **Skanderborg Fælled/ Sports and Administration Centre/ Town Hall Skanderborg/Denmark**

The new Sports and Administrations Centre and Town Hall in Skanderborg is the first Danish public building to reach the DGNB Platinum Standard, the highest certification under the Danish DGNB sustainability standard.

In 2017, the Green Building Council Denmark completed a thorough certification process of the completed project, which included 182 different parameter in terms of environmental, financial and technical quality. The project scored high on all parameters, and especially the building's overall economy performance as an energy-efficient building of high quality for a low overall economy was emphasised.

The new 18,000 m<sup>2</sup> Sports and Administration Centre offers multiple administrative facilities for the municipality of Skanderborg in combination with new sports facilities for the use of the entire community. The aim is a complex, which sets new standards, supporting an innovative and multi-disciplinary work culture as well as being a vibrant gathering point for citizens of Skanderborg. The project appears informal, open, and accessible and in close contact with the unique surroundings of the recently established natural resort, Anebjergskov.

Several sustainable measures are integrated in the design of the building, such as optimized use of daylight, natural ventilation and an efficient building envelope. Green plants grow on selected facades as solar screening whilst increasing local biodiversity, as well as indoor green walls contribute to a good indoor climate.

More info available on the project's website/ [www.skanderborgfaelled.dk/](http://www.skanderborgfaelled.dk/)



# Vendsyssel Theatre/ Hjørring/ Denmark

A dynamo for cultural life



**Architect**/ Schmidt Hammer Lassen Architects **Size**/ 4,200 m<sup>2</sup> **Competition**/ 2013, 1st prize in restricted competition **Client**/ Municipality of Hjørring/ Realdania **Landscape Architect**/ LIW Planning Aps  
**Engineer**/ Brix & Kamp A/S/ ALECTIA A/S **Visuals**/ Beauty & the Bit **Awards**/ 2017, City of Hjørring Architecture Prize **Status**/ Opened January 2017





### **Vendsyssel Theatre/ Hjørring/ Denmark**

The cultural life in Vendsyssel and the region's identity and self-awareness have been strengthened through the establishment of a new theatre in Hjørring city centre. The building is a dynamo for cultural life throughout northern Jutland, thus supporting both settlement, education and business.

Vendsyssel is an area with a long and proud tradition of art and culture, and the new theatre contributes to the cultural life of the region as a cultural lighthouse for the entire regional cultural life of Nordjylland. At the same time, Hjørring's new theatre building helps to create renewed activity and coherence in the city.

The vision of the new theatre has been to reinvent the role of cultural institutions as part of the city's public space. In addition, it serves as a gathering place and growth layer for local youth and the non-organized people who are interested in music, theatre and cultural life.

The theatre is a visionary building that contributes to strengthening the already strong cultural life in Vendsyssel. In addition, the theatre will help to make the city and the municipality more attractive for attracting competent employees and ultimately creating settlements.

The ambition for the new theatre has been to create a building, which blends into the surrounding environment while standing out as a new, vibrant organism in the city. The architectural and functional concept has five main themes: integration in the city, openness, functionality, flexibility and materiality. The result is a significant building, which relates to its function in a pragmatic way.

The dynamic and multifunctional complex includes four halls; Music hall (190 seats), Black Box (150), rehearsal hall and a large flexible hall with up to 430 seats that can be set to "in-the-round" theatre.



# Shenzhen East Waste-to-Energy Plant/ Shenzhen/ China

The world's largest waste-to-energy plant



**Architect**/ Schmidt Hammer Lassen Architects **Size**/ 112,645 m<sup>2</sup> **Competition**/ 2016, 1st prize, international competition **Client**/ Shenzhen Energy Environmental Engineering Ltd. **Partner architect**/ Gottlieb Paludan Architects  
**Structural Engineer**/ Schlaich Bergermann Partners **Visuals**/ Beauty & the Bit





## Shenzhen East Waste-to-Energy Plant/ Shenzhen/China

**In 2016, Schmidt Hammer Lassen Architects in collaboration with Gottlieb Paludan Architects won the international competition to design the world's largest waste to energy power plant in Shenzhen, China.**

Located on the outskirts of Shenzhen, the Shenzhen East Waste-to-Energy Plant will incinerate 5,000 tonnes of waste per day, generating 550 million kWh every year. With a population of 20 million, Shenzhen produces 15,000 tonnes of waste a day, a number that is increasing approximately 7% per year. To counteract this, Shenzhen Energy wishes to build a new plant that not only uses the most advanced technological processes in waste incineration but also act as a source of education for the citizens of the city.

The proposal organizes the entire plant, including auxiliary buildings, into one circular building breaking the traditional rectangular layout of an industrial power plant. By proposing a clean circular form, the footprint of the plant reduces the amount of excavation required to build on the site.

Public visitors are invited into the plant through a landscaped park, via an entrance bridge that rises between the stacks to an entrance lobby and visitor centre overlooking the plant machinery. An internal circular path and walkway circle the plant explaining each process, before leading up to a 1.5km panoramic public walkway on the roof overlooking the surrounding landscape and back towards the city.

The roof is designed to be covered by up to 44,000m<sup>2</sup> of photovoltaic panels, providing the opportunity for the plant to not only provide a cleaner way to deal with the city's waste but also contribute to the renewable energy provision for the city.

The plant is intended to showcase the Waste to Energy production as an important technical process that is geared to deal with both the issues of growing waste, but also the issue of finding new more environmentally friendly ways of generating electricity. At the same time, visitors can become informed on the challenge of the growing waste we produce every day and be educated on initiatives on how we can reduce our own amount of daily waste.

Schmidt Hammer Lassen has built a reputation for bringing a strong Scandinavian design approach to large complex public projects in China. Detailed design work is due to begin during 2016, and the plant is scheduled to go live in 2020.



# The Green Tower/ High-rise build as a sustainable community

**schmidt/hammer/  
lassen/**



**architects/**



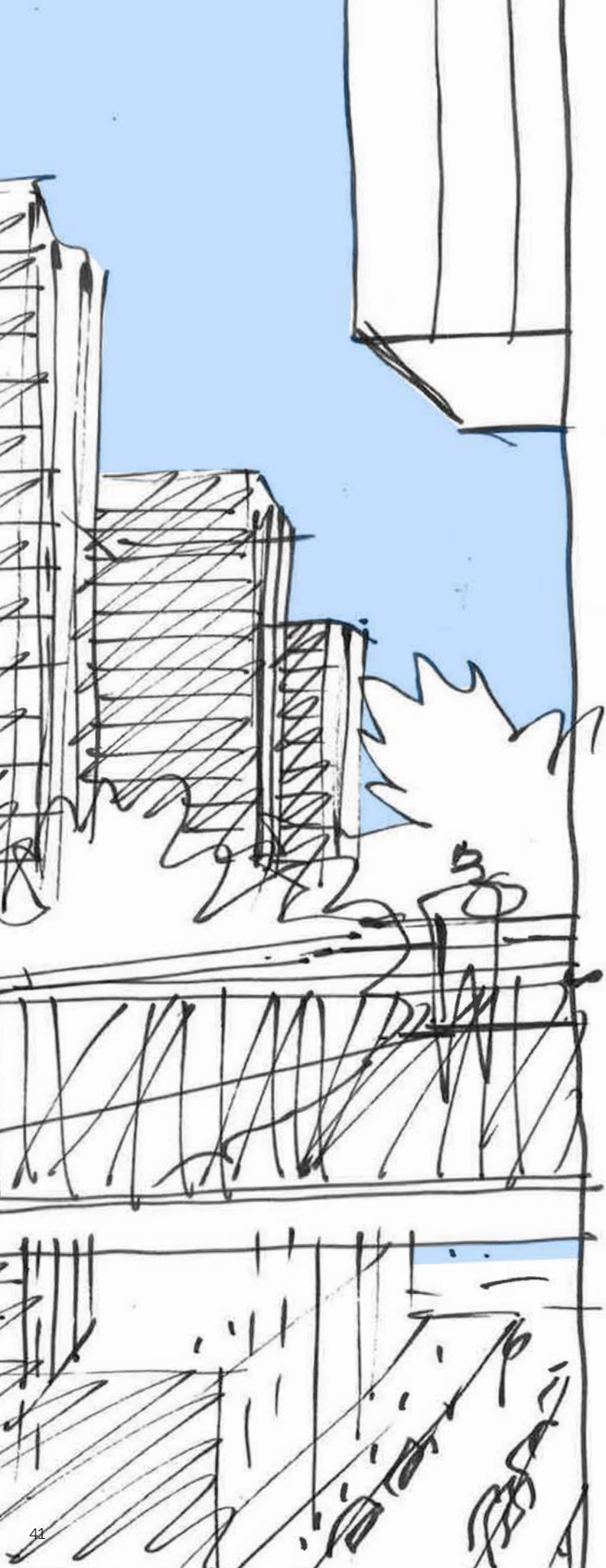

**With this project we wanted to explore, how high-rise build  
in timber can be organized as a sustainable community.**

Morten Schmidt, senior partner





## The Green Tower/

### A new typology

Schmidt Hammer Lassen have developed a new high-rise concept. The concept proposes a new typology for high rises. As oppose to the common method of designating fixed units for sale, this project proposes to design a structural framework for housing units, community facilities, and vegetation to be infilled at later stages.

This approach creates the flexibility for a high-rise to serve multiple purpose through time. It is adaptable spatially, socially and economically. This type of building may serve as a green wall in the dense urban area at one point and then infilled by modular housings at a later stage.

Modularity is a key factor in this typology. Prefabricated units can simplify the construction and allow units to be expand or reduced upon demand. Yet, the types of modules can be variable to create different spatial and social opportunities over time.

### Sustainable Housing

Development of contemporary cities and urban environments is often operating on traditional and even outdated approaches for residential high-rise, designing towers that only address the demand for housing and utilizing obsoleted techniques, that organize family units into compact and isolated order.

Over time, this type of housing can be prone to become a burden to our cities' environmentally and socially and effect degrading of market value. It is crucial to develop a new housing typology that considers the whole environment for a sustainable lifestyle, Sustainable Housing solutions. The total environment for sustainable housing converges three key aspects: environment, community and building construction.



# International Criminal Court/ The Hague/ Netherlands/

A landmark for peace and justice



**Architect/** Schmidt Hammer Lassen Architects **Client/**The International Criminal Court (ICC) **Area/** 54,000 m<sup>2</sup> / 1,200 workplaces **Competition/** 2008-2010, first prize in restricted international competition  
**Engineer/** Royal Haskoning Nederland B.V. and Esbensen - Consulting Engineers AS **Landscaping/** SLA **Project management/** Brink Group **Interior & Art/** Bosch & Fjord **Contractor/** Courtys



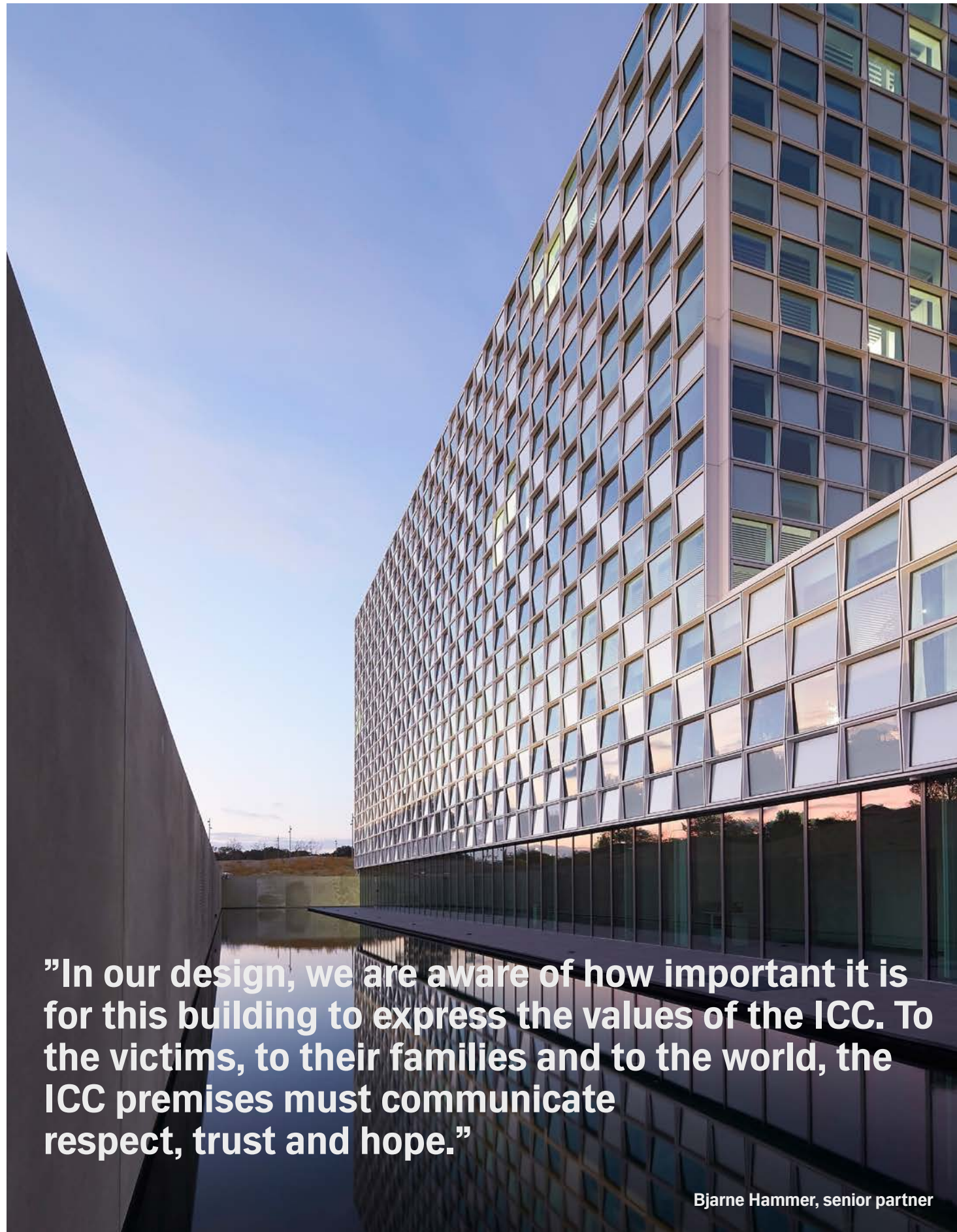

**"In our design, we are aware of how important it is for this building to express the values of the ICC. To the victims, to their families and to the world, the ICC premises must communicate respect, trust and hope."**

**Bjarne Hammer, senior partner**

## **International Criminal Court/ The Hague/ Netherlands**

In 2010, Schmidt Hammer Lassen Architects won the prestigious architectural design competition for the new permanent premises of the ICC with an experienced interdisciplinary team of consultants. The design was selected for its understanding of the concept of transparency. The design also shows how democratic values upon which the Danish tradition for architecture rests, reflect in an international institution that is subject to some of the strictest security requirements in the world.

### **Safety and openness**

In the design approach it has been paramount that the security measures, as much as possible, are an integrated part of the design. The public has easy and open access to the main entrance and the design of the landscape surrounding the building achieves a highly secure environment without the appearance of barbwire and high fences.

### **The landscape**

The new ICC headquarters is located between the edge of the Hague city and the Meijendel Dune Landscape, which is a protected Natura 2000 area. One of the primary and most important aims of landscape architects SLA's concept is to 'reunite' the site with this dune landscape. The primary idea has been to locate the complex as a cut in the landscape, establishing an interior that relates to the international collectivity of the ICC, and an exterior that entrenches the ICC to the local Dutch landscape and opens it to the public.

### **Sustainability**

The new headquarters for the ICC is targeting a BREEAM Excellent certification. The complex is part of the local water-win area. Therefore strict local regulations applied for materials, their possible leaching and work during the construction period. Several environmental sustainability measurements have been implemented into the design such as: a heat-and cold storage, which is the largest of its kind in the Netherlands, green roofs, water-saving taps and toilets, automatic daylight control of luminaires for all lighting in offices and biological cleaning of the mirror pond.



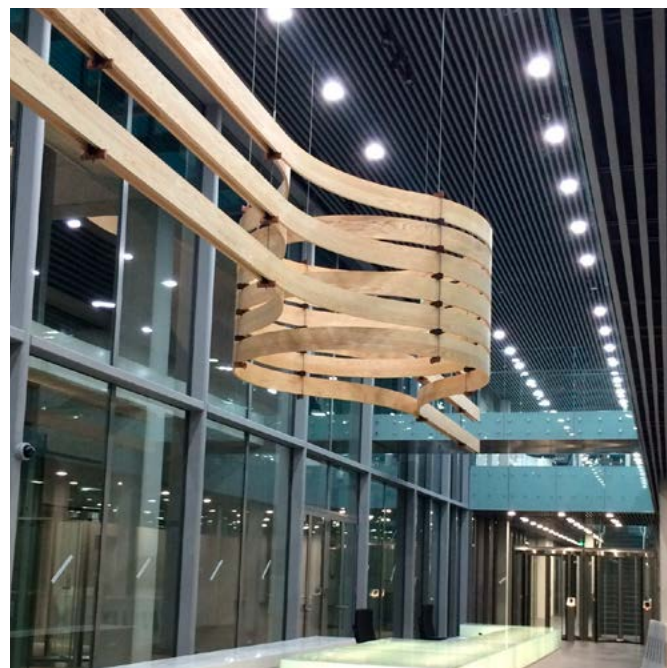



**The library/**  
A new generation of public buildings

**schmidt/hammer/  
lassen/**

**PUBLIC  
LIBRARY  
OF THE  
YEAR  
AWARD  
2016**

AGENCY FOR CULTURE AND PALACES  
**SYSTEMATIC**

### **Public Library of the Year Award/ 2016**

In 2016, the visionary hybrid library project, Dokk1 in Aarhus, Denmark, was announced winner of the Public Library of the Year Award at a prestigious ceremony during the International Federation of Library Associations and Institutions (IFLA) congress in Columbus, Ohio. The international panel of judges recognised Dokk1 as a true library of the future, that embraces new digital developments, user demands, local culture, and a desire to accommodate diverse population groups within an open and functional architectural expression.

The Dokk1 project also scooped an A+ Popular Choice Award in 2016 in the Library category. The event organized by Architizer brought together an eclectic mix of architects and designers from around the globe.

**architects/**



# DOKK1/ Aarhus/ Denmark/

## Space for change



**Architect/** Schmidt Hammer Lassen Architects **Client/** Aarhus Municipality **Client Partner/** Realdania **Area/** 35,600 m<sup>2</sup> **Competition/** 2009, first prize in an international competition  
**Engineer/** Alectia Rådgivende Ingeniører **Landscaping/** Arkitekt Kristine Jensens Tegnestue **Client Consultant/** Rambøll Danmark **Other consultants/** Bahn arkitekter (accessibility)



“Dokk1 is not simply a building. It is a place for exchanging knowledge and opportunities and a multicultural meeting point that will change people’s perception of the entire city“

Kim Holst Jensen, senior partner



## **DOKK1/** Aarhus/ Denmark/

**Dokk1 opened its doors to the public in 2015. Situated by the historic harbour front of Aarhus the largest public library in Scandinavia today represents a new generation of modern, hybrid libraries.**

### **Democratic, open and diverse**

The 30,000 square metre building is part of the Urban Mediaspace project, and houses the new library, a citizen service centre, automatic parking for 1,000 cars and new harbour-side public squares. New cycle paths run through the scheme that includes over 450 bicycle parking spaces, and the new light railway will run with a station at Dokk1.

The new library has already become a new vibrant hub and a connecting “hinge” that opens up to new experiences in the city of Aarhus.

The two open levels of the library are connected by the media ramp, which consists of five platforms dedicated to numerous activities: exhibitions, gaming, interactive workshops, reading and events. Combined with the literature and media sections, the media ramp offers a meandering path of activity through the building leading up to the children’s area on the top floor.

### **A covered urban space**

The principal idea behind Dokk1 is a transparent covered urban space, designed as a polygonal slice that hovers above a glazed building resting on a podium with large sculptural stairs. The stairs fan out to street level and the new harbour promenade surrounding the building. The glass building is designed as an open urban space with 360-degree views of the water, harbour, forest and city.

The building has no clear front or back, which is emphasised by the multi-edged top slice that creates the impression of rotation and movement. The facade is made of expanded metal, the scale of the city and harbour is reflected in the design, which twists, breaks and turns. The concept of the façade design is an interaction with the height of the surrounding buildings and the scale of the port with reference to large elements, such as cranes and ships.

### **Sustainability**

From the earliest stage, sustainability has been an important integrated part of developing the project, and the building meets the requirements of the Danish 2015 energy classification. Elements such as seawater cooling, effective shielding effects and the 3,000 m<sup>2</sup> integrated roof solar cells reduces energy consumption considerably. Also light fittings, LED lamps, motion and daylight sensors as well as solar panel arrays reduces dependency on conventional energy sources.



**Schmidt Hammer Lassen Architects have extensive experience with library design. The most renowned of these being the extension to the Royal Library in Copenhagen, Denmark, the RIBA award-winning University of Aberdeen New Library in Scotland and Dokk1 in Aarhus, Denmark. In 2018 a new central library in Christchurch, New Zealand, will open, and in 2020 the new Central Library in Shanghai, China.**

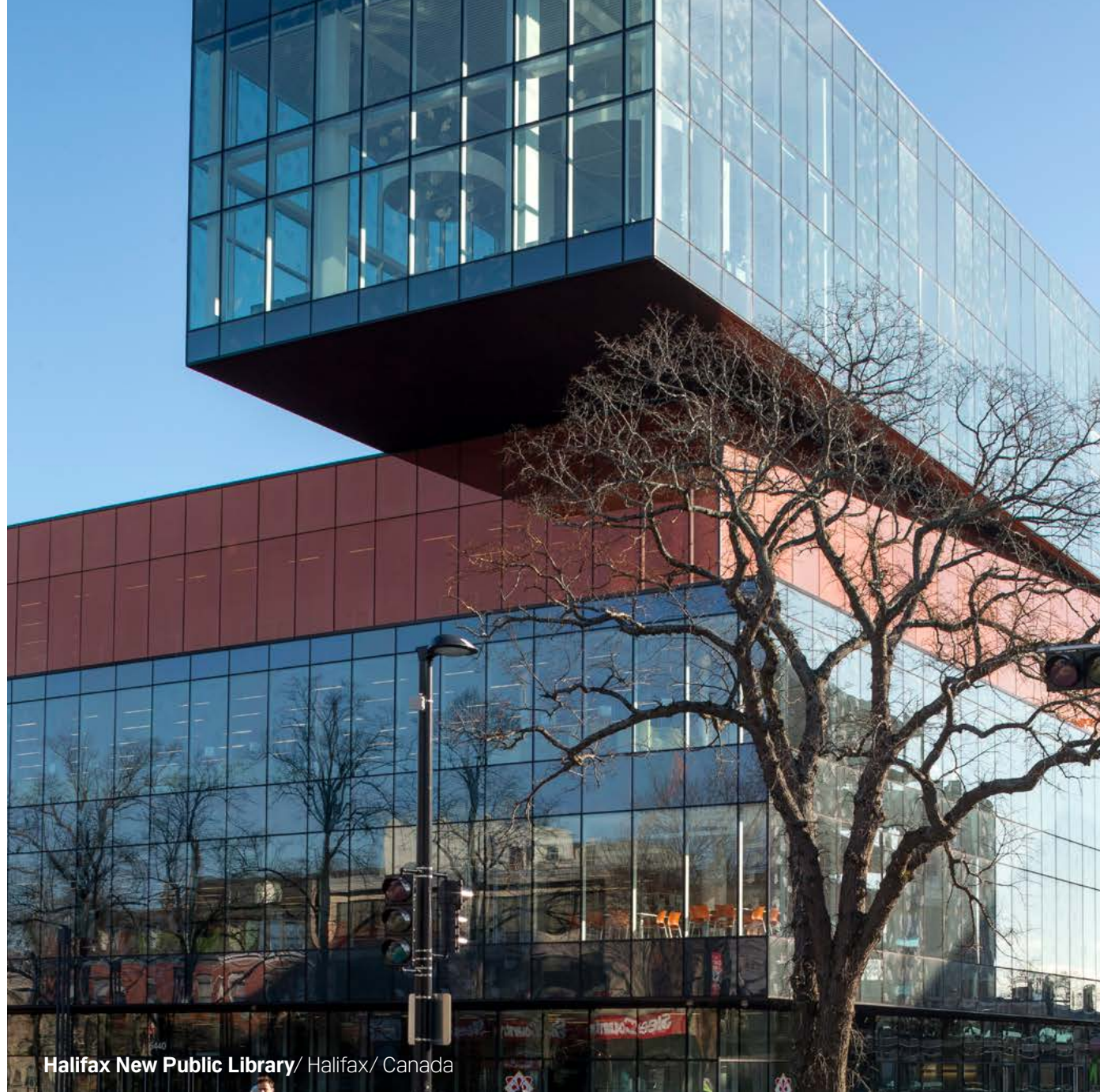

Halifax New Public Library/ Halifax/ Canada

### **The Library/ driver of social cohesion**

In social sciences, public spaces such as libraries, city halls and culture centres are defined to be cornerstones of the democratic society. These places enable encounters and active citizenship of society. This makes the public building an important facilitator for social cohesion of society, and architecture is a driving part of this.

### **User involvement/**

Schmidt Hammer Lassen and the City of Aarhus received a Best Collaboration Award in 2012 for the extensive cooperation in creating the largest public library in Scandinavia, DOKK1.

The Best Collaboration Award awards the best examples of collaboration between partners from the creative industries sector and local governments in the North Sea Region of the European Union. The jury selected the DOKK1 project team due to the broad and intensive collaboration process between the municipality, the architects, the citizens and future users.

The philosophy behind the user involvement is that an active library will only come to life by actively involving the people who are going to use it. Therefore, citizens of Aarhus and the future staff of the library has been engaged in the design process throughout the whole process.

### **Halifax Central Library awarded/**

The 14,500 m<sup>2</sup> Halifax Central Library is the most significant public building to be built in Halifax in a generation, and represents the diverse communities, talents, and creativity of the residents of Halifax throughout the municipality and present this to the world. The library is sited in a prominent position in downtown Halifax.

In 2016, The Halifax Central Library was awarded a Governor General's Medal for its outstanding new civic building design, created by Schmidt Hammer Lassen Architects and local studio Fowler Bauld & Mitchell. The Governor General's Medal in Architecture awarded by the Royal Architectural Institute of Canada (RAIC) and the Canada Council for the Arts celebrates outstanding architectural design in Canada.



# Malmö Live/ Malmö/ Sweden/

A city in the city



**Architect/** Schmidt Hammer Lassen Architects **Client/** Skanska Sverige AB **Area/** 54,000 m2 concert, congress and hotel **Competition/** 2010, international property development competition  
construction 2010 - 2015 **Landscape architect/** SLA **Contractor/** Skanska Sverige AB **Other collaborators/** Akustikon





**The Malmö Live complex in Southern Sweden, was awarded a prestigious 1st prize in the Mixed-use Completed Buildings category at a ceremony during the World Architectural Festival 2016 in Berlin.**

**The Jury praised the project as a public building in the best sense of the word: open to everyone, inclusive and very democratic: “It’s a real piece of the city and an important catalyst of urban regeneration”**

## **Malmö Live/** Malmö/ Sweden/

### **A city in the city**

In 2015 the new 54,000 square metres large concert, congress and hotel complex situated on Universitetsholmen in Malmö was completed. The building consists of a composition of cubic volumes that are mutually twisted and given different sizes to meet the directions and building heights of the surrounding city. The façades are designed with a homogeneous expression to make the composition appear as one architectonic sculpture.

The ground floor is open to the public. The main entrance is found at the northern part of the building, with a classic loggia-motif facing the plaza in front. The different functions in the building are organised

like separate elements – like a small town. Here, the lobby becomes the street that runs through the whole ground floor plan and ties everything together. Like the medieval cities, with curved and narrow streets organised around plazas and squares, the lobby is designed to form small gathering places and recesses where it is possible to stop, sit and enjoy the view to the canal and the park.



“The main idea of Malmö Live has been to create ‘a city in the city’. An example is the part of the building that faces the park and the canal that is shaped more openly and organic, and gives the people from the city the possibility to stroll through the building if they are going to a concert, a conference, to the café or just want to make a shortcut. We wanted the place to be vibrant, accessible, and inviting – no doubt this approach will have great impact on the future life to be unfolded around and inside the buildings.”

Kristian Ahlmark, senior partner

### **Open and accessible**

The new cultural centre becomes an open, expressive and dynamic building that is manifold in both its activities and its architecture. The point of departure for the building design is the modern Scandinavian architectural tradition with the clear functional organisation and the accessible and open ground floor lay-out. The building becomes the focal point and a landmark for Malmö – a place where the spirit of the city, the diversity and the intimacy is given an architectonic expression.

### **Sustainability profile**

Malmö Live is a sustainable, green project. The intention is to develop the area with as little environmental impact as possible, for example by reducing energy consumption and using local energy sources such as geothermal heating, solar energy and wind power.

Close proximity to City Tunnel and Central Station makes taking public transport easy. Green roofs absorb water, slow up runoff and promote biodiversity. Solar cells meet some of the building's energy requirements. Food waste is collected and turned into biogas, and there are nesting boxes for kestrels on the roofs to help this bird of prey to live in a city environment.

Malmö Live will be certified according to the international Leadership in Energy and Environmental Design (LEED) standard - aiming for the highest level - platinum - in the assessment, which looks at factors like materials, indoor environment, design, and water use. The building also meets the category A standard of the Miljöbyggprogram Syd Green Construction Programme.



# Green Valley/ Shanghai/ China/

Transformation as driver



**Lead design architect**/Schmidt Hammer Lassen Architects **Local architect**/ECADI /East China Architecture and Design Institute **Client**/Shanghai EXPO Construction Development Co. Ltd. **Area**/50,000 m<sup>2</sup> **Competition**/2012, 1<sup>st</sup> prize in invited international competition **Status**/Construction period 2013 – 2015



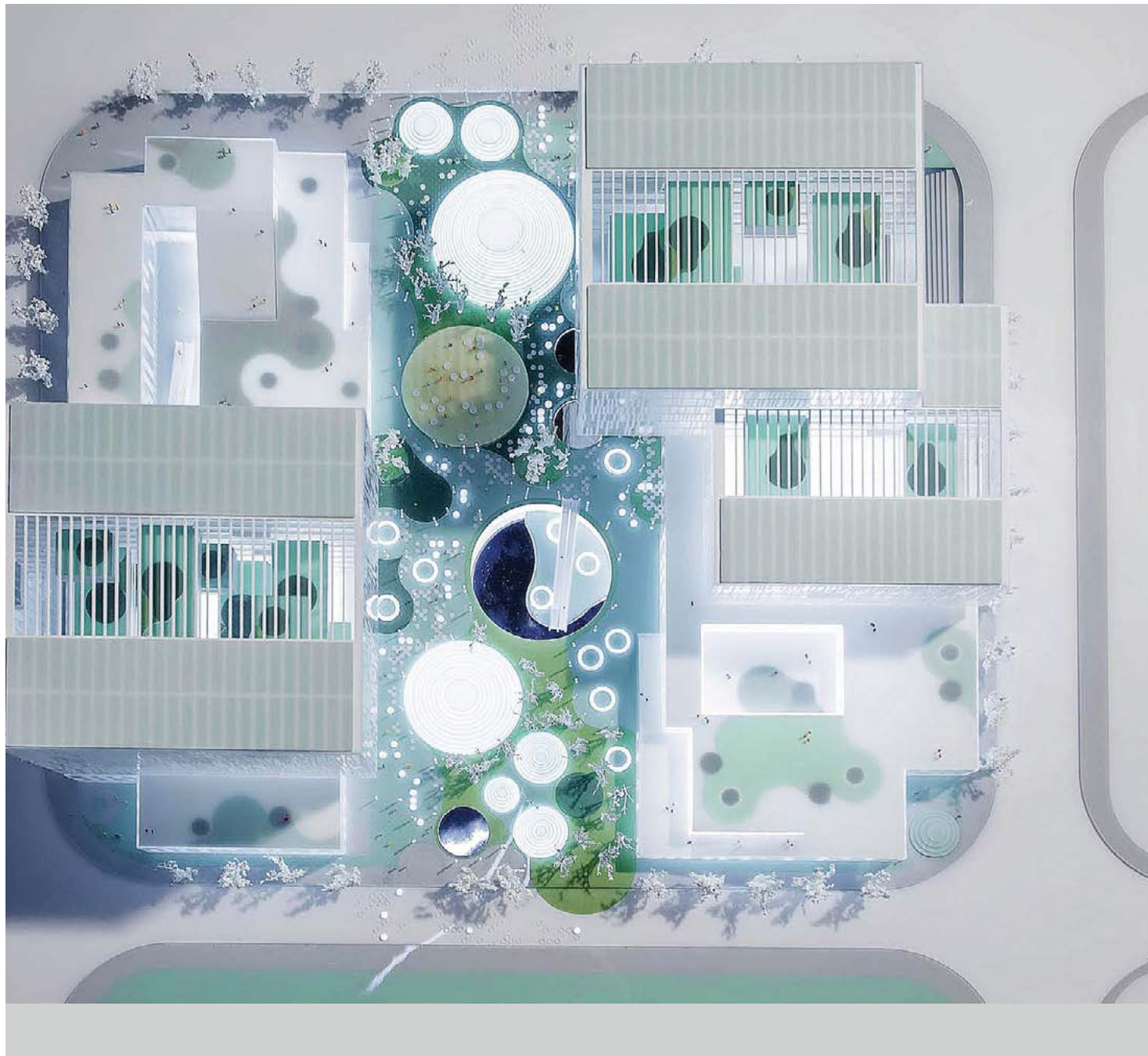

## **Green Valley/ Shanghai/ China/**

**The Green Valley project is located on the former 2010 Shanghai World Expo site immediately next to the iconic Chinese pavilion. The Green Valley development is part of the new central urban development of Shanghai, integrating new sustainable solutions in both the urban design and the individual buildings on the site.**

Green Valley is just one of several major projects along Shanghai's historical Huangpu River waterfront being designed by Schmidt Hammer Lassen.

All the projects relate to the redevelopment of the former industrial areas along the riverfront, and build on the studio's track record in regenerating a number of prominent waterfront sites in major cities throughout Scandinavia. Besides Green Valley, our studio is involved in the Shanghai Dream Center development, a former cement factory being converted into Shanghai's new waterfront cultural and creative hub.

Schmidt Hammer Lassen also won the prestigious competition to design the new 125,000-square-metre city Library of Shanghai. The main library volume floats above two pavilions that will house a 1200-seat performance venue, exhibition and event space and a dedicated children's library. They will all open up towards a series of landscaped courtyards and gardens.

**"Despite the monumental scale of the site, the project relates to the human scale in the public spaces, giving a diverse, vibrant and inclusive community."**

Chris Hardie, partner





All rights in this COP is reserved by Schmidt Hammer Lassen Architects

**Contact/**

Njalsgade 17A  
Pakhus 2  
2300 Copenhagen S.  
Denmark  
T +45 86 20 19 00  
info@shl.dk  
www.shl.dk

**Graphic design/**

Schmidt Hammer Lassen Architects

**Photos/**

Hufton + Crow  
Thomas Damgaard Jensen  
Adam Mørk  
Anders Back  
Daniel Greniman  
Jeppe Carlsen  
Ricky Molloy  
Schmidt Hammer Lassen Architects

**Global Compact/CSR/contact point/**

Trine Steffenauer/trs@shl.dk

**We support/**

Schmidt Hammer Lassen Architects hereby states that we operate in accordance with The UN Global Compact's ten principles in the areas of human rights, labour, the environment and anti-corruption. We state that our actions comply with Danish national legislation and related international conventions. This COP reports on the continued commitment and describes actions taken within all four areas.