

**ROTORUA**  
LAKES COUNCIL

## **COMMUNICATION ON ENGAGEMENT (COE)**

**Period covered by this Communication on Engagement**

**May 2015 to 7 May 2017**



**COMMUNICATION ON  
PROGRESS**

This is our **Communication on Progress** in implementing the principles of the **United Nations Global Compact** and supporting broader UN goals.

We welcome feedback on its contents.

## Part I. Statement of Continued Support by Rotorua Lakes Council Mayor



THE OFFICE OF THE MAYOR

7 March 2017

His Excellency Mr A. Guterres  
Secretary-General of the United Nations  
New York, NY 10017  
USA

Tēnā koe

I am pleased to confirm that the Rotorua Lakes Council supports the ten principles of the United Nations Global Compact with respect to human rights, labour, environment and anti-corruption. With this commitment, we express our intent to advance these principles as part of the *Rotorua 2030 Vision*.

In this Communication of Engagement, we describe the actions that our organization has taken, through the Rotorua Sustainable Living Strategy – Toitū te orange o Rotorua, to support the UN Global Compact and its Principles

We commit to sharing this information with our community stakeholders and others using our established channels of communication.

Nāku noa, nā

Hon Steve Chadwick JP  
Mayor

**ROTORUA  
LAKES COUNCIL**  
Te kaunihera o ngā roto o Rotorua

Civic Centre  
1061 Haupapa Street  
Private Bag 3029  
Rotorua Mail Centre  
Rotorua 3046  
New Zealand

Please Quote: 01-28-052  
Doc No: RDC-707217

## Part II. Description of Actions

*Have a dedicated sustainability plan or a holistic city/ regional plan that incorporates the ecological, economic, political and cultural dimensions of the region's sustainability.*

*Utilise assessment tools and methodologies developed by the Global Compact Cities Programme, and sharing knowledge and innovations developed with the use of these tools.*

*Engage at the Leader level of the Global Compact Cities Programme.*

Rotorua Lakes Council joined the United Nations Global Compact Cities Programme in May 2015. Early in 2015 a steering group of community members with interests in a range of topics relating to sustainable living came together with Councillor Janet Wepa and Council staff to begin the journey to develop a strategy for sustainable living contributing to achieving the Rotorua 2030 goals:

Rotorua 2030 Goals Tatau Tatau - we together	
1. A resilient community...	He hāpori pūmanawa...
2. Homes that match needs...	Kāinga noho kāinga haumaruru...
3. Outstanding places to play...	Papa whakatipu
4. Vibrant city heart...	Wāhi pūmanawa...
5. Business innovation and prosperity...	Whakawhanake pakihi...
6. Employment choices...	He huarahi hou...
7. Enhanced environment...	Tiakina to taiao...

On our path to become a Leading City Participant, the team used the Programme's 'City Scan' tool to assess a range of attributes contributing to sustainability issues for our district. We used this material to engage with our communities and develop our Sustainable Living Strategy- Toitū te oranga o Rotorua.

[http://www.rotorualakescouncil.nz/Rotorua2030/portfolios/sustainableliving/Documents/Sustainable\\_Living\\_020816/index.html?page=1](http://www.rotorualakescouncil.nz/Rotorua2030/portfolios/sustainableliving/Documents/Sustainable_Living_020816/index.html?page=1)

We also engaged with the Cities Programme to research particular topics to understand current research and practices globally in the areas of: processing food/organic waste, Energy and Carbon Accounting, Mobility, Housing and Food.

The model we developed representing how our communities view sustainability incorporates Māori concepts regarding the relationships between people, the living and built environments, the spiritual world and economy.

# Te tauira toitū oranga o Rotorua

## Rotorua model of sustainable living



The resulting strategy focuses on six particular objectives:

- He hapori pūmanawa, He hapori ngāwari - People are resilient to change, and able to adapt and thrive
- Kia tau te iwi o Rotorua ki te nuinga ngā kai ora, ngā kai pai ki te tiaki te mauri tū, te mauri ora - People in Rotorua will at all times have access to enough safe and nutritious food for a healthy and active lifestyle
- Ka noho te iwi i ngā kāinga whakaruru, ngā kāinga haumarū - People live in affordable healthy homes
- Toitū te papa, Toitū te wai, he tuarā mo te taiao - Our land and water is sustainably managed and supports the natural environment
- Mimiti atu ai ngā para, ka whai tikanga te wāriu - We minimise our waste and recover its value
- Kei te takatū a Rotorua mo te ao hōu, mai te mahi tiaki, me te mahi whakakorengia ngā hau 'greenhouse' - Rotorua will be ready for the approaching post-carbon economy through greater energy efficiency and reduction in greenhouse gas emissions

***Acknowledge participation in the Global Compact publically and promoting the initiative and the ten principles within our sphere of influence.***

Rotorua Lakes Council has taken the opportunity to share our journey developing our Sustainable Living Strategy and our participation in the Global Compact Cities Programme at a number of fora including:

- 10 December 2015 - Skype presentation to United Nations Association meeting in Wellington, New Zealand (R Viskovic and Councillor J Wepa)
- February 2016 - Ethical Cities Forum - Round 1, Melbourne- Presentation (Hon Steve Chadwick, Mayor)
- April 2016 (ongoing) - Discussion with Air New Zealand, the only UN Global Compact business participant in New Zealand
- July 2016 - PrepCom III, Indonesia - Skype presentation to Urban Speakers Corner event (R Viskovic)
- October 2016 - Remote presentation/video to Habitat 3 conference in Quito (R Viskovic)
- 27 October 2016 - Presentation to Sustainable Business Network, Bay of Plenty Regional meeting and subsequent national journalist interview (R Viskovic and Deputy Mayor Dave Donaldson)
- April 2017 - Promotion of UN Global Compact to Local Government New Zealand and Bay of Plenty region councils (Hon Steve Chadwick, Mayor)
- April 2017 - Making Global Goals Local Business, India - Remote presentation (Hon Steve Chadwick, Mayor)
- Ongoing - Sharing UN Global Compact news with local Rotorua Sustainable Business Charter, Sustainable Living Portfolio Control Group and others in our community



*Engage at the Innovating Level - undertaking a multi-year project to address a complex or seemingly intractable issue(s) within the city or region, which is supported by leaders across business, civil society and Government*

**The Sanatorium Reserve Restoration Project** has been identified as our Innovating Level Project. It is in the very early stages of investigation; scoping the ecological and biodiversity requirements and early discussion with potential business partners.

The project focuses on the restoration of the reserve's indigenous vegetation and biodiversity in an active geothermal area alongside enhancement of walking and cycling tracks that enable up-close iconic experience of the environment. The reserve is a short walk from the city centre. At the south-eastern end, the reserve links to the start of Te Ara Ahi New Zealand Cycle Trail network leading towards the Whakarewarewa Forest and renowned mountain-biking and walking trails.

Sulphur Point within the reserve demonstrates magnificent examples of steaming vents and boiling mud pools, sitting right on the shores of Lake Rotorua. On the southern shores of Sulphur Bay, the walkway passes through the area known as Te Arikiroa, where centuries ago a battle raged on the sandy lake beach. The site was given the name Waiwhitiinanga to commemorate the battle between



the tribes Ngāti Tangaroa-mihi and Ngāti Tama. At the north-western end, the reserve connects with the historic Government Gardens, including the Rotorua Museum which is housed in the magnificent Elizabethan-style Bath House building which is a monument to the New Zealand Government's first major investment in the tourism industry. From the Government Gardens, it is a short walk around the urban Lake Rotorua waterfront to the Māori village of Ohinemutu, home of Ngāti Whakaeu who gifted the land on which the city of Rotorua was built. There is opportunity to recognise significant Māori and settler historical and geothermal ecological features across the reserve through interpretative signage.

## Sustainability

### The environment - kaitiakitanga

The southern end of Lake Rotorua has hosted successive waste water treatment plants since 1898 and until 1969, the town dump. This is an opportunity to remedy these years of damage to the environment. Rotorua Lakes Council is upgrading the wastewater treatment plant at a cost of \$32m.

The plant currently produces the best quality treated water in New Zealand, but will be further improved due to the need to stop discharging treated water into our forest. Ecosystem re-entry mechanisms are being developed with the objectives including the restoration of the mauri of the water and its life-supporting capacity.



A new approach has been proposed and will be further developed with mātauranga Māori experts, mana whenua, hapū and iwi, involving land contact beds following the wastewater treatment plant and prior to ecosystem re-entry (the following diagram shows the draft land contact beds design). It aims to address the cultural requirements. The overarching cultural imperative is to restore the mauri (life-force) of the wai (water), as well as show Kaitiakitanga (care of the environment) and incorporate the principle that water is intrinsic to life and therefore also needs to sustain life and be life-sustaining.



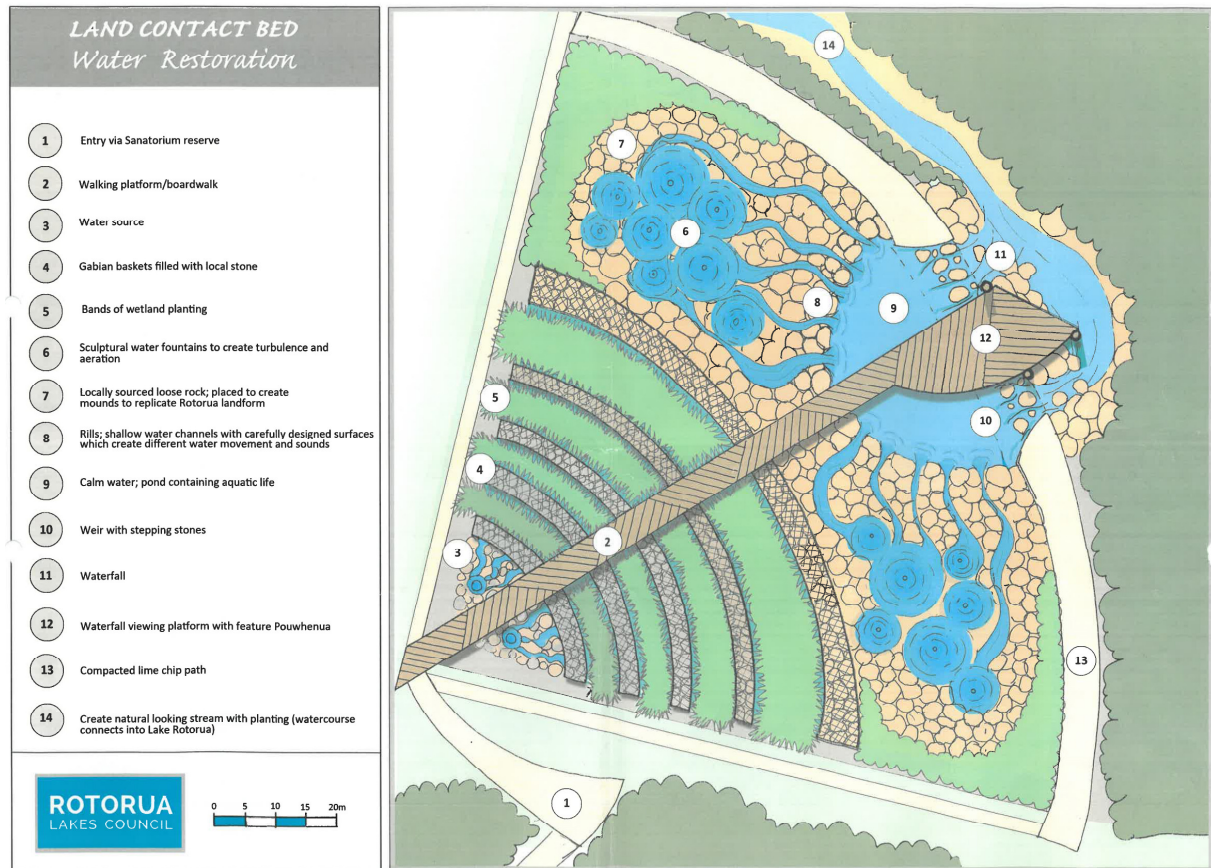

The project requires pest plant and animal eradication for protection and enhancement of biodiversity in particular native birdlife and vegetation in the unique geothermal surroundings. The Sulphur Bay Wildlife Refuge occupies a 145 ha portion of the bay and is home to an array of bird species including the nationally threatened New Zealand dabchick, banded dotterel and black-billed gull. Specialised geothermal vegetation with needle – like leaves, slow growth rates and irregular flowering habits include turutu (blueberry) growing along the edges of the paths in clumps and raupo (bullrush) can be seen growing in the water at the lakes edge. An unusual and rare prostrate kanuka grows on the thermal soils.





## Social - Manaakitanga

The project will provide opportunity for recognition of local iwi history and stories about the landscape. A number of community partnerships may contribute in voluntary labour for clearing and planting in identified locations, including the Rotorua Trails Trust, various running and walking groups that use the existing trails and Conservation Department volunteer groups. The Council also works very closely with Ngāti Whakaue and will collaborate on developing interpretive signage to tell the many stories of the area. There is opportunity to provide learning and research opportunities for Waiariki Bay of Plenty Polytechnic and secondary school students.



## Economy - Ōhanga ora

The project will complement the Rotorua tourism unique proposition of contemporary Māori culture, adventure mountain-biking and world spa with a highly accessible reserve with geothermal features for which Rotorua is renowned, located right on the door step of the city centre and most visitor accommodation. The walking and cycling is on flat terrain and largely wheelchair accessible catering for people of all ages and abilities. The reserve is adjacent to Te Ara Ahi national cycle trail as well as the historic Government Gardens, Rotorua Lakefront activities and Ohinemutu Māori village. The value of enhancement of this location is an excellent visitor experience contributing to our tourism business sector and further developing the eco-tourism offering.



## Our Potential Partners

Te Tatau o Te Arawa, Ngāti Whakaue, Department of Conservation, Bay of Plenty Regional Council, Te Arawa Lakes Trust, Pukeroa Oruawhata Trust, Rotorua Sustainable Business Charter, Toi Ohomai Institute of Technology, United Nations Global Compact Cities Programme, wider Rotorua community and business groups.

## Part III. Measurement of Outcomes

---

Progress on key strategies from our Sustainable Living Strategy:

### The Ten Principles

The **UN Global Compact** encourages companies to embrace, support and enact, within their sphere of influence, a set of core values in the areas of human rights, labour standards, the environment, and anti-corruption.



#### Human Rights

**Principle 1:** Businesses should support and respect the protection of internationally proclaimed human rights; and  
**Principle 2:** make sure they are not complicit in human rights abuses.



#### Labour

**Principle 3:** Businesses should uphold the freedom of association and effective recognition of the right to collective bargaining;  
**Principle 4:** the elimination of all forms of forced and compulsory labour;  
**Principle 5:** the effective abolition of child labour; and  
**Principle 6:** the elimination of discrimination in respect of employment and occupation.



#### Environment

**Principle 7:** Businesses should support for a precautionary approach to environmental challenges;  
**Principle 8:** undertake initiatives to promote greater environmental responsibility; and  
**Principle 9:** encourage the development and diffusion of environmentally friendly technologies.



#### Anti-Corruption

**Principle 10:** Businesses should work against corruption in all its forms, including extortion and bribery.

Strategy	Outcomes	UN Global Compact Principles
<b>Celebrate our Te Arawa heritage</b>	<ul style="list-style-type: none"> <li>• Te Tatau o Te Arawa representatives participating on Council committees; supporting iwi partnership with Council</li> <li>• Te Amorangi programme increasing the capability of Council staff- in the last year:               <ul style="list-style-type: none"> <li>○ 34% of staff have attended noho marae (Overnight marae stay and cultural workshops)</li> <li>○ 31% of staff have attended reo (Māori language) classes</li> <li>○ 350 staff have attended a Treaty or Te Arawa Stories lecture</li> </ul> </li> </ul>	1, 2, 6
<b>Promote social and economic inclusion through collective impact approaches</b>	<ul style="list-style-type: none"> <li>• Positive Ageing Rotorua group established to provide an aged perspective on Council issues</li> <li>• Dementia-friendly Rotorua Steering Group comprising a wide range of community partners and projects including Dementia-friendly Christmas Carol Service, Affinity Light Sculpture hosting (approximately 8000 visitors)</li> <li>• Developing a new model of youth engagement and participation with community youth providers</li> <li>• Participation in 'Rotorua Working Together Forum'- a network of community groups and agencies identifying and responding to locally identified issues</li> <li>• Hosted the McGuinness Institute 'Tackling Poverty NZ' workshop in our community and supporting development of 'Demarcation zone policy'- devolving central governance powers to local geographic area</li> <li>• Public digital access through library and proposal to extend in inner city</li> <li>• Establishment of a Diversity and Inclusion Policy and internal Council forum</li> <li>• Council confirmed its support for the Women's Empowerment Principles (April 2017)</li> </ul>	1, 2, 3, 4, 6



Strategy	Outcomes	UN Global Compact Principles
<b>Improve urban design to foster stronger connections to our culture, environment and between our people</b>	<ul style="list-style-type: none"> <li>• Spatial plan development underway</li> <li>• Smokefree Outdoor Spaces Policy extended to include all playgrounds, youth spaces, reserves, lakefronts, sports grounds, bus stops, and Council funded or located events, with a further extension to all outdoor eating places and the entrances/ exits to all public buildings from 2018</li> <li>• Two Neighbourhood Reinvigoration Projects underway</li> <li>• Assessment of accessibility of Ngongotaha community public spaces</li> <li>• Integrated Library and Child Health Hub project implementation underway</li> </ul>	7, 8, 9
<b>Enhance safety in our communities</b>	<ul style="list-style-type: none"> <li>• New collaborative model for Safe Rotorua network, accredited with Safe Community Foundation NZ</li> <li>• Support community worker development</li> </ul>	1, 2, 3, 4, 5, 6, 10
<b>Provide information to enable people to connect to others and access service</b>	<ul style="list-style-type: none"> <li>• New online Council engagement tool</li> </ul>	1
<b>Collaborate through a network approach to address local food security</b>	<ul style="list-style-type: none"> <li>• Rotorua Local Food Network established with projects including Community gardens, teaching gardening and food preparation, community fruit harvesting, support for social enterprise development; connection of philanthropic groups</li> <li>• Neighbourhood Matching Fund grants support community and home vegetable garden development and teaching</li> </ul>	7, 8, 9
<b>Advocate for healthy food environments</b>	<ul style="list-style-type: none"> <li>• Aquatic Centre Food Policy developed and implemented</li> <li>• Continue to provide public drinking water fountains in locations where there are numbers of children and youth as a priority</li> </ul>	7, 8, 9
<b>Plan for Rotorua district's future quality housing needs</b>	<ul style="list-style-type: none"> <li>• Investigation of housing needs undertaken</li> <li>• Developing project to establish a Community Housing Trust to sustainably maintain and grow our social housing stock</li> <li>• Participation in Rotorua Homeless Action Plan group</li> <li>• Participation on Bay of Plenty Housing Forum</li> </ul>	1, 8, 9

Strategy	Outcomes	UN Global Compact Principles
<b>Encourage new home building and renovation which provides affordable and energy/ resource efficient homes</b>	<ul style="list-style-type: none"> <li>Implementation of new Eco-design Home Performance Advisory Service to provide independent home assessment and advice to home owners and occupiers</li> </ul>	1, 8, 9
<b>Treat our waste water to a high standard and discharge safely</b>	<ul style="list-style-type: none"> <li>Te Arawa perspectives incorporated in proposal; preliminary design and consent prepared for Wastewater Treatment Plant upgrade</li> </ul>	1, 7, 8, 9
<b>Work with stakeholders to protect and promote biodiversity</b>	<ul style="list-style-type: none"> <li>Host public meeting presentation by Environmental Defence Society</li> <li>Support connection and information sharing between community environmental groups with Department of Conservation and Bay of Plenty Regional Council</li> <li>Neighbourhood Matching Fund supports community environmental restoration projects</li> </ul>	7, 8
<b>Encourage diversification of land use to reduce environmental impacts</b>	<ul style="list-style-type: none"> <li>Support horticultural trial of nut trees, riparian planting, work with Bay of Plenty Regional Council and through District Plan rules to reduce nitrogen impact on lake water</li> </ul>	7, 8, 9
<b>Protect geothermal ecosystem and features</b>	<ul style="list-style-type: none"> <li>Rotorua Geothermal Working Party participation</li> </ul>	1, 7, 8, 9
<b>Avoid and minimise waste</b>	<ul style="list-style-type: none"> <li>Implemented new waste and recycling kerbside collection service resulting in total 95% uptake on recycling bins, almost doubling of recycling volumes and a 30% reduction in waste overall to landfill</li> <li>Public education and awareness raising- regular workshops including: 'The Nappy Lady' waste-free parenting; worm-farming and composting</li> <li>Implemented Para Kore programme working with marae to increase the reuse, recycling and composting of materials</li> </ul>	7, 8, 9
<b>Develop a carbon abatement plan</b>	<ul style="list-style-type: none"> <li>Project proposal being developed</li> <li>Council part of regional council energy efficiency collective</li> <li>Civic Centre has transferred to geothermally heated building</li> </ul>	7, 8, 9

Strategy	Outcomes	UN Global Compact Principles
<b>Reduce fuel use for transport through planning and design</b>	<ul style="list-style-type: none"> <li>• Suburban cycleway network under development</li> <li>• Implemented monitoring of pedestrian and cycling volumes across key locations</li> <li>• Strong local participation in Bikewise month 2017, by both Council employees and businesses</li> <li>• Support continued events to promote cycling and safety including ‘Frocks on Bikes’, school safety</li> <li>• Support for Bay of Plenty regional project to develop electric vehicle recharging station network</li> </ul>	7, 8, 9

**Report Author:**

Rosemary Viskovic  
 Strategic Development Manager- Sustainability and Social Development  
 Rotorua Lakes Council  
 May 2017